

# WQA-Chlorine Free/Total Chlorine Water Quality Analyzer

## Overview

The WQA-Chlorine is an on-line free/total chlorine analyzer that measures free/total chlorine in water using the DPD colorimetric method. The automatic DPD pumps reagents into the water sample for reaction and determines the water concentration by colorimetry. By selecting different reagents, the analyzer can measure either free or total chlorine.



## Application

- Tap water factory water
- Tap water network
- Secondary water supply of tap water
- Medical wastewater

## Features

- With self-diagnosis, abnormal alarm, data exceeding the standard alarm function
- Interval measurement optional, minimum 5min
- Supports Modbus RS485 and 4-20mA signal outputs
- Support 4G, WiFi wireless data transmission

## Specifications

<b>Measurement method</b>	DPD method
<b>Range</b>	fCl: 0-2 mg/L, 0-5 mg/L, 0-10 mg/L tCl: 0-2 mg/L, 0-5 mg/L, 0-10 mg/L
<b>Accuracy</b>	0.001 mg/L
<b>Resolution</b>	±5% or ±0.05 mg/L
<b>Dimension</b>	300×300×180 mm (11.81×11.81×7.09 inch)
<b>Weight</b>	4 kg
<b>Power requirements</b>	100-240 VAC, 50/60 Hz
<b>Power consumption</b>	25 W
<b>Installation</b>	Wall-mounted
<b>Pressure</b>	0.2 ~ 2 bar
<b>Operating temperature</b>	5-45 °C (41-113 °F)
<b>Storage temperature</b>	5-45 °C (41-113 °F)
<b>Humidity</b>	20% - 95%, indoor
<b>Cable length</b>	6 m (6.56 ft), Please contact us for other sizes
<b>Tubing requirements</b>	Inlet/Outlet: 6 mm outer diameter
<b>IP rating</b>	IP54
<b>Communication</b>	RS485(Modbus RTU), WiFi/Bluetooth, 4G, LoRa
<b>Analog output</b>	0/4 - 20 mA
<b>Digital input</b>	1
<b>Digital output</b>	2
<b>Data storage</b>	32 GB SD card
<b>Sampling requirements</b>	Temperature: 5-45 °C (41-113 °F) Flow rate: 250 - 500 mL/min; Pressure: no more than 1bar, in water flow at 5-45 °C (41-113 °F)
<b>Warranty period</b>	1 year

In no event will the manufacturer be liable for direct, indirect, special, incidental or consequential damages resulting from any defect or omission in this manual. The manufacturer reserves the right to make changes in this manual and the products it describes at any time, without notice or obligation.



Dimensions

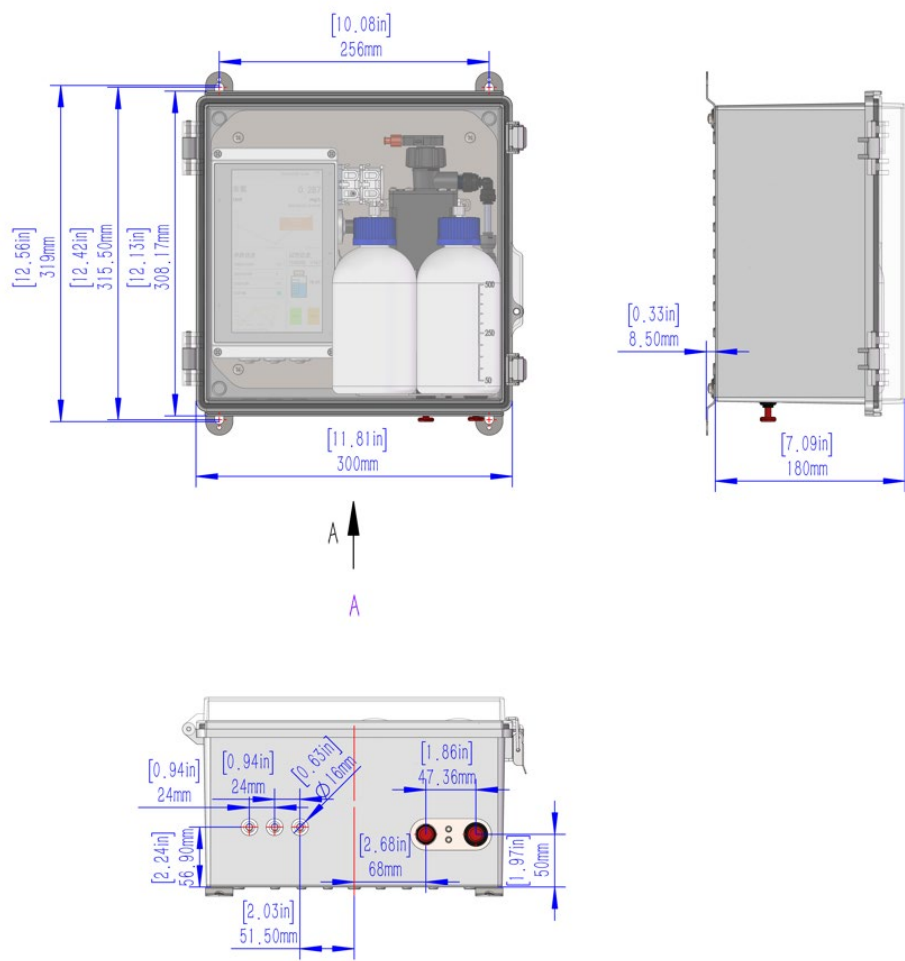

## Spare Parts

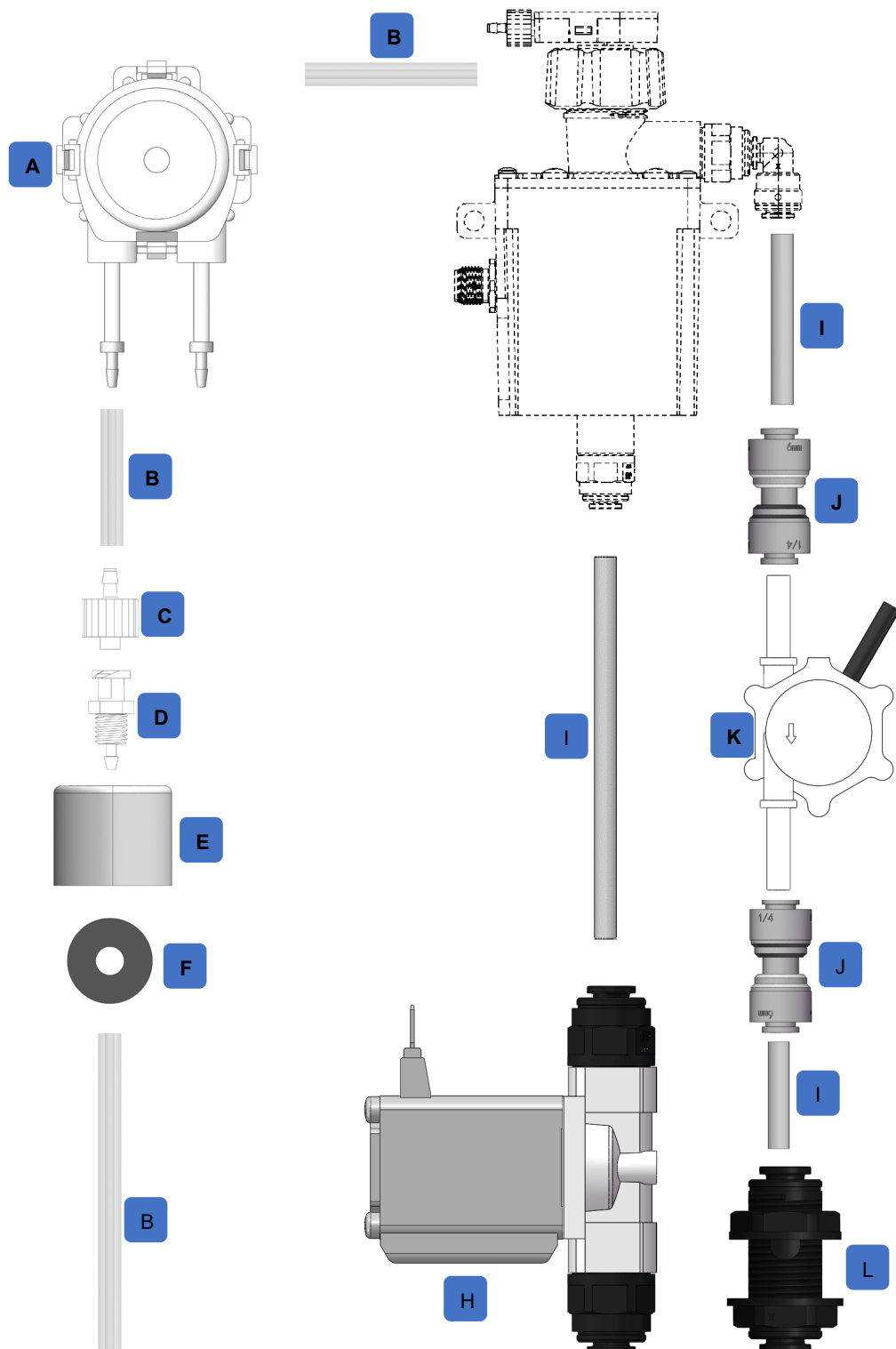

## Spare parts list

Letter	Name	Qty. per set	Encodings
A	KPP pump	1	PRT010485
B	Reagent hose	3	SPZL003217
C	Luer female connector	1	SPZL001439
D	Luer through-panel connector	1	PRT010386
E	Bottle cap GL32	1	PRT010392
F	Silicone gasket	1	PRT010607
H	Solenoids	1	PRT007784
I	6mm tube	3	SPZL002657
J	Connection	2	SPZL002373
K	Flow sensors	1	SPZL001486
L	Bulkhead Joints	1	SPZL001536

